

CAPPRIATA, SCALA 1:50

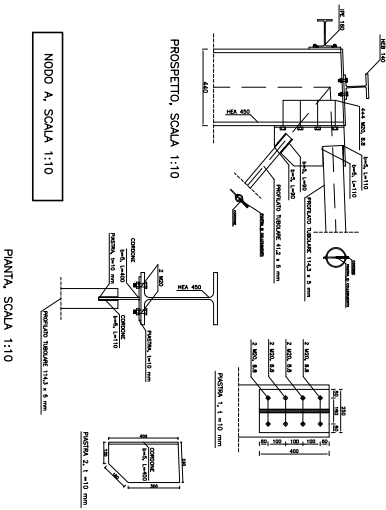

PIANTA, SCALA 1:10

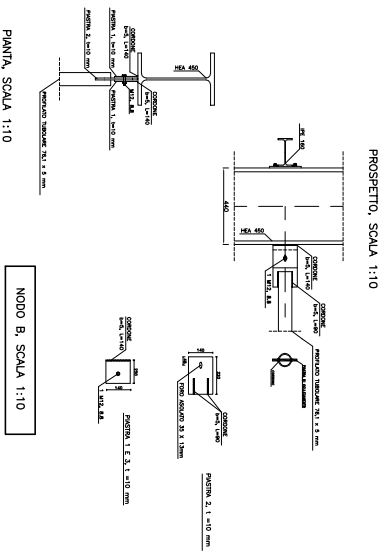

PIANTA, SCALA 1:10

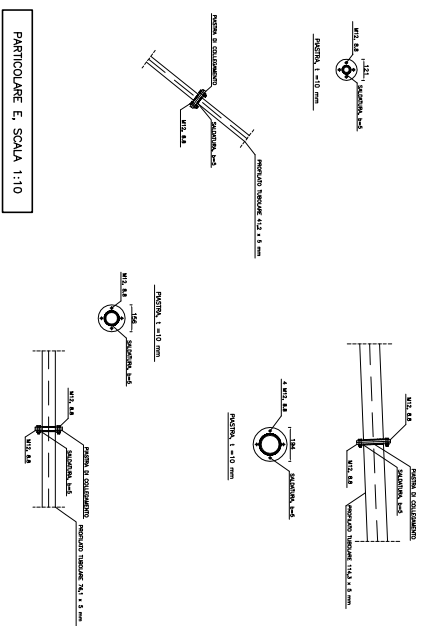

PARTICOLARE E, SCALA 1:10

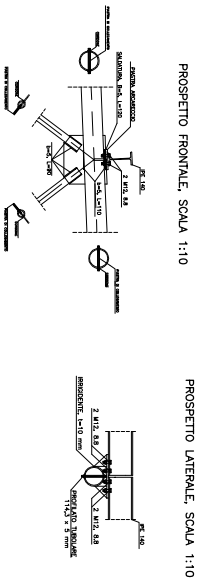

PROSPETTO FRONTALE, SCALA 1:10

PROSPETTO LATERALE, SCALA 1:10

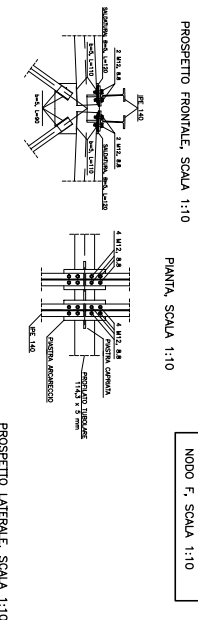

PROSPETTO FRONTALE, SCALA 1:10

PIANTA, SCALA 1:10

NODO F, SCALA 1:10

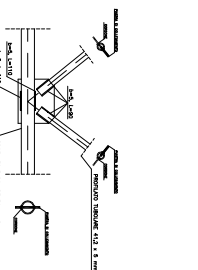

NODO C, SCALA 1:10

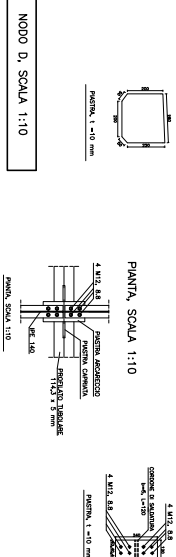

NODO D, SCALA 1:10

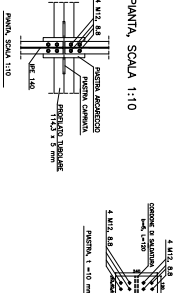

PIANTA, SCALA 1:10

UNIVERSITA' DEGLI STUDI DI  
FIRENZE

FACOLTA' DI INGEGNERIA  
CORSO DI LAUREA IN INGEGNERIA CIVILE

CORSO DI TECNICA DELLE COSTRUZIONI  
ANNO ACCADEMICO 2009-2010

STUDENTE  
ALFREDINELLA  
DIRETTORE  
FRANCESCO GIANNINI  
PROF. ING. GIORGIO MORANDI  
INDAGATORE  
ING. MARIO VASILETTA

PROGETTO DI UN EDIFICIO IN  
ACCIAIO

TAVOLA  
3

OGGETTO:  
CAPPRIATA

NOTE:

ACCIAIO: S235

S235